

Sebghatollahi Manufacturing

The Sebghatollahi manufacturing factory manufactures rolling machineries in order to present the rolling technology called Namira; using world's modern technology and with an expert and experienced staff, it is proud to present these products with the best quality to all industrialists. These products increase the speed of work, reduce costs and save in raw materials and without the need of expert work force, you can have all types of rollings with high quality.

Products

- Namira-3 Bolt Rolling Machine 8-16mm
- Namira-4 Bolt Rolling Machine 14-30mm
- Namira-5 Bolt Rolling Machine 24-50mm
- Namira-6 Bolt Rolling Machine 34-80mm
- Rolling Machine for Gas and Water Pipes
- Rolling Machine for Concrete Cast Threaded Bolt
- Namira-10 Two-Roller Rolling Machine
- Namira-20 Machine for Milling Construction Bolts



The Technology of Creating Threads

One of the methods for manufacturing threads or generally, parts with spiral grooves is Tread Rolling or Roll Threading operation. In this method, chip removal is not performed on the work piece, yet a cold forming operation is done, therefore, the strength of these type bolts are much higher than bolts that have been turned or grinded.

Creating Threads by the Rolling Method



The wire's structure has not been damaged and due to the pressure, it will have higher strength.

Namira-3 Rolling Machine

Namira-3 is able to thread bolts with 8-16 mm diameter (equal to 5/16-5/8 inches). The thread length is adjustable to minimum 5 mm and maximum 600 mm.

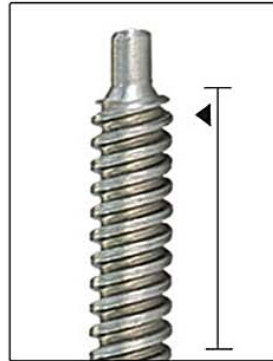

This machine is available with installing the Zs3 group of heads according to the following table:

Description	Diameter & Pitch Max.	Diameter & Pitch Min.	Head Type
Regular Right-Handed Thread	M 16x2	M 8x0.75	ZS3RH
Regular Left-Handed Thread	M 16x2	M 8x0.75	ZS3LH
Trapezoid Right-Handed Thread	TR 16x4	TR 8x2.5	ZS345RH
Trapezoid Left-Handed Thread	TR 16x4	TR 8x2.5	ZS345LH
Trapezoid & Multi-track Right-Handed Thread	TR 16x6	TR 8x3	ZS310RH
Trapezoid & Multi-track Left-Handed Thread	TR 16x6	TR 8x3	ZS310LH





Namira-4 Rolling Machine

It is able to thread bolts with 14 - 30mm diameter (equal to 9/16- 1 1/4 inches).
 The thread length is adjustable to a 5mm minimum and 600mm maximum.



This machine is available with installing the ZS4 group of heads according to the following table:

Description	Diameter & Pitch Max.	Diameter & Pitch Min.	Head Type
Right-Handed Fine-Ridge Bolts	M 30x2	M 14x0.75	ZS401 RH
Left-Handed Fine-Ridge Bolts	M 30x2	M 14x0.75	ZS401 LH
Regular Right-Handed Ridge Threads	M 30x3.5	M 14x2	ZS4 RH
Regular Left-Handed Ridge Threads	M 30x3.5	M 14x2	ZS4 LH
Trapezoid Right-Handed Threads	TR 24x6	TR 14x3	ZS445 RH
Trapezoid Left-Handed Threads	TR 24x6	TR 14x3	ZS445 LH
Construction Round-Thread & for Concrete Cast Pipe	M 22x10	M 14x6	ZS410



This machine is available with installing the ZS5 group of heads according to the following table:

Description	Diameter & Pitch Max.	Diameter & Pitch Min.	Head Type
Right-Handed Threads	M 50x5	M 24x2.5	ZS525 RH
Left-Handed Threads	M 50x5	M 24x2.5	ZS525 LH
Trapezoid & Multi-track Right-Handed Threads	TR 50x8	TR 24x4	ZS535 RH
Trapezoid & Multi-track Left-Handed Threads	TR 50x8	TR 24x4	ZS535 LH



Namira-5 Rolling Machine

It is able to thread 5mm bolts with 24-50mm diameter (equal to 1-2 inches) and trapezoidal thread bolts with TR 24x3 thru TR 50x6 diameter.

The thread length is adjustable to a 15mm minimum and 900mm maximum.

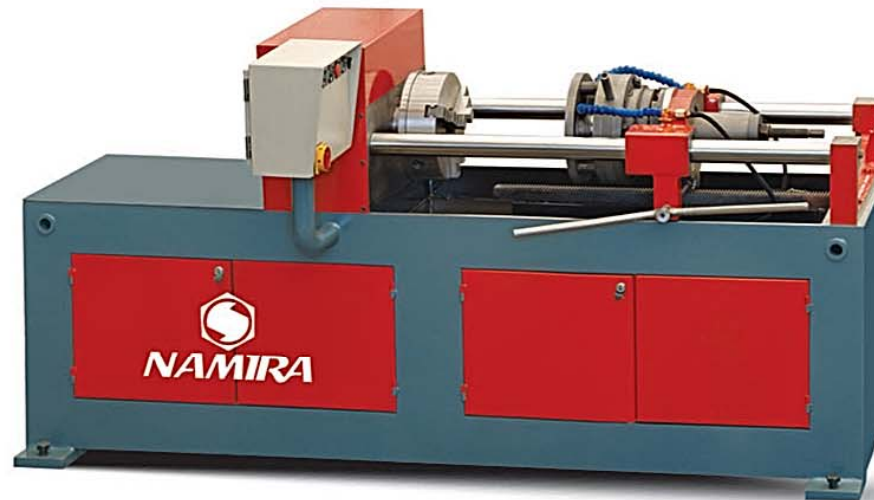

Namira-6 Rolling Machine

It is able to thread bolts with 34-80mm diameter (equal to 1 3/8-3 inches).

With Namira-6 and the C60 Hydraulic group, the roofing jack-head pipe can be manufactured, which with this system, without making the part oval, the pipe's entire length can be threaded, which is manually placing the part in the machine and easily exiting the pipe from the hydraulic colette.



This machine is available with installing the ZS6 group of heads according to the following table:

Description	Diameter & Pitch Max.	Diameter & Pitch Min.	Head Type
Regular Right-Handed Threads	M 80x5	M 34x3	ZS625 RH
Regular Left-Handed Threads	M 80x5	M 34x3	ZS625 LH
Trapezoid & Multi-track Right-Handed Threads	TR 80x10	TR 34x5	ZS635 RH
Trapezoid & Mutil-track Left-Handed Threads	TR 80x10	TR 34x5	ZS635 LH



Rolling Machine for Gas & Water Pipes

- a. Rolling Machine for 1/2 thru 1 inch NAMIRA 4-S pipes
- b. Rolling Machine for 1 thru 2 inches NAMIRA 400 pipes
- c. Rolling Machine for 2 1/2 thru 4 inches NAMIRA 500 pipes



This machine is manufactured in three types of manual, semi-automatic and automatic. All the three above models can be used with the C60 - C30 - C20 hydraulic groups that is a sample of the semi-automatic machine. Since these groups perform the task of taking the pipe with the colette, therefore the pipes never become oval (something that occurs with the two systems and the three systems) and the user can easily perform the open and close and threading tasks with an accelerated speed (automatically).

By using the above mechanisms, even a pipe with a 3.5 cm length can be threaded. In the automatic mode, using a hydraulic cutting saw and rolling, the threading task is done in a machine. Due to the high quality of threading and the angle precision without the need of sealing materials (adhesives, Teflon, tube paste) its seals to a standard level.

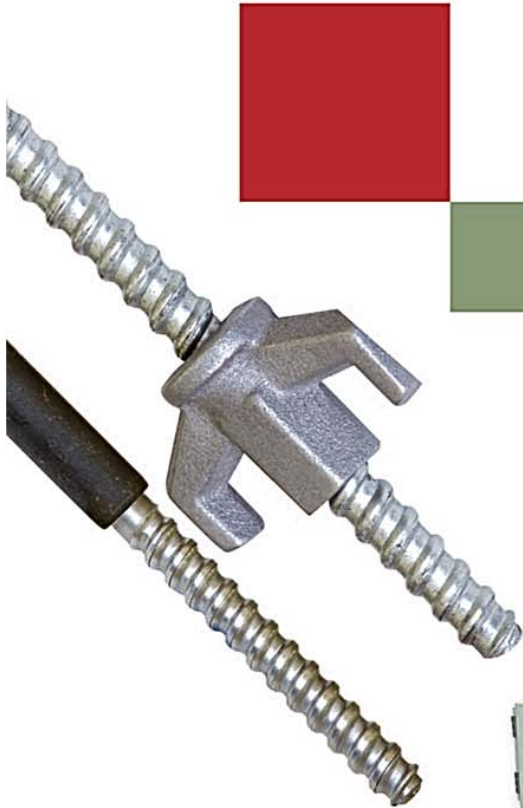

Rolling Machine for Concrete Cast

- a. NAMIRA 410 Rolling Machine
- b. NAMIRA 510 Rolling Machine

The NAMIRA 510 Rolling Machine is for manufacturing parts with longer lengths and in higher quantities with less depreciation and longer lifetimes.



NAMIRA-20 Machine for Milling Construction Bolts

This machine is available in two 20-36 models (ability to mill construction bolts with 14 thru 36mm diameter) and 20-50 model (ability to mill construction bolts with 14 thru 50 mm diameter). Since the work piece (bolt) and the tools' rotation is stable, it has a high capability in milling construction bolts with long lengths and high precision.

- Liner Guid Way
- Hydraulic Clamp System
- Equipped with PLC central control system in order to control the speed, mode and optimizing the device's operations
- The touch monitor (HMI) helps the operator to easily enter the speed and mode and also the times.
- Area Sensor (Digital Ruler): by installing the area sensor, there is no need for different microswitches and the support mode can be precisely determined.
- Inverter (Engine Speed Control): using an appropriate speed control in this specific application has led to the electricity consumption to be reduced up to 30%.
- Remote flaw detector system can be installed upon the customer's request.

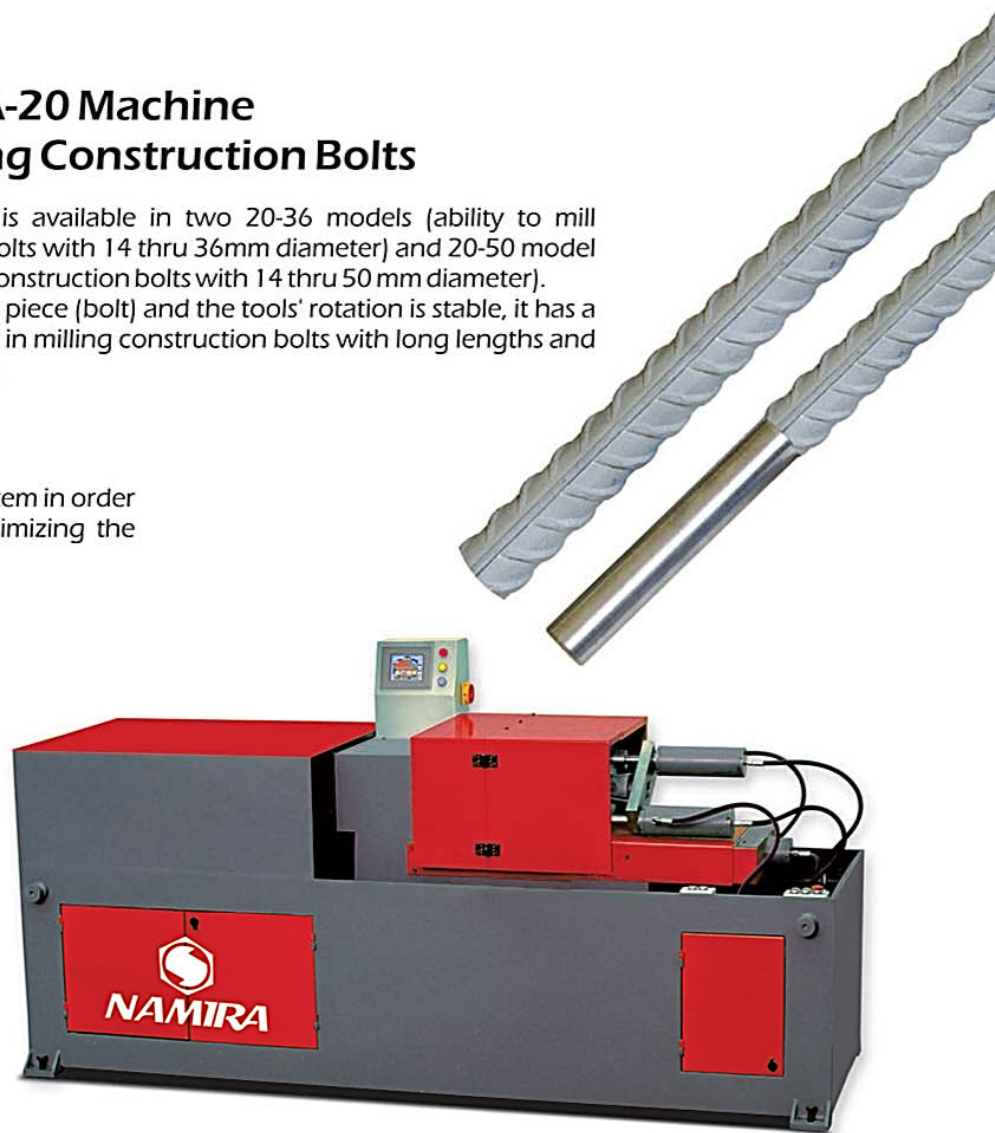



NAMIRA-10 Two-Roller Rolling Machine

This machine is used for manufacturing bolts with 5 thru 36mm diameter and 0.02mm precision rate. In this machine without closing the work piece and by placing it manually by hand or by robot, between the two turning rollers and enforcing pressure, the profil bar creates and completes the thread.

One of the most important capabilities of this machine is the complete threading of the bolt up to the last ridge with hundredth mm precision. This machine is manufactured in two types of automatic and semi-automatic, that in each type the amount of force entered onto the bolt, the roller's speed and threading speed can be adjusted through the HMI touch system.

This machine has the capability to create single millimeter and single inch threads and has threads with specific profil bars. For optimizing energy consumption and to increase the capability to control all parts, the HMI touch monitor is used.

The remote flaw detector system can be installed up on the customer's request.



ماشین رولینگ نامیرا ۳-

نامیرا ۳- قادر است پیچ از قطر ۸mm الی ۱۶mm و معادل آن پیچ های اینچ از قطر $\frac{5}{16}$ الی $\frac{3}{8}$ را رزوه کند.

طول رزوه حداقل ۵ mm و حداکثر ۶۰۰ mm قابل تنظیم است.

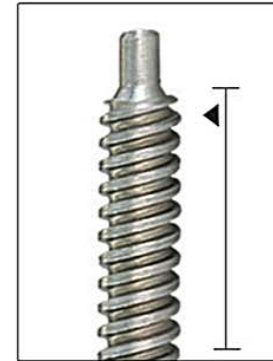

این ماشین با نصب هد های گروه (ZS3) طبق جدول ذیل قابل عرضه می باشد:

نوع هد	حداکثر قطر و گام	حداکثر قطر و گام	توضیح
ZS3RH	M 8x0.75	M 16x2	رزو معمولی راستگرد
ZS3LH	M 8x0.75	M 16x2	رزو معمولی چپگرد
ZS345RH	TR 8x2.5	TR 16x4	رزو نوژنقه راستگرد
ZS345LH	TR 8x2.5	TR 16x4	رزو نوژنقه چپگرد
ZS310RH	TR 8x3	TR 16x6	رزو نوژنقه چندراهه راستگرد
ZS310LH	TR 8x3	TR 16x6	رزو نوژنقه چندراهه چپگرد





The Sebghatollahi R&D Manufacturing Unit is ready and prepared to design and manufacture all types of hot and cold rolling and all types of special rollers for optimizing the mechanical characteristics of the product and creating all types of forms and threads.

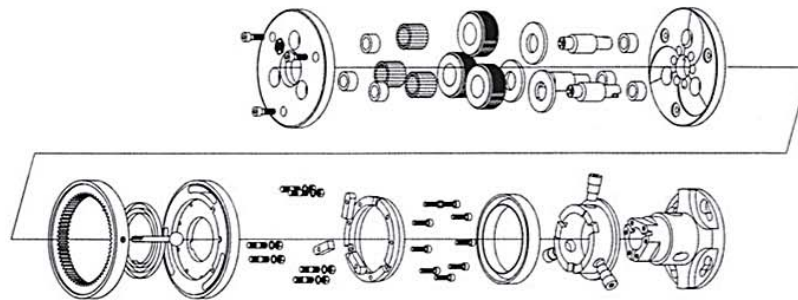

Holder of 5 invention registration certificates in the Rolling technology field





NAMIRA
Sebghatollahi
Manufacturing

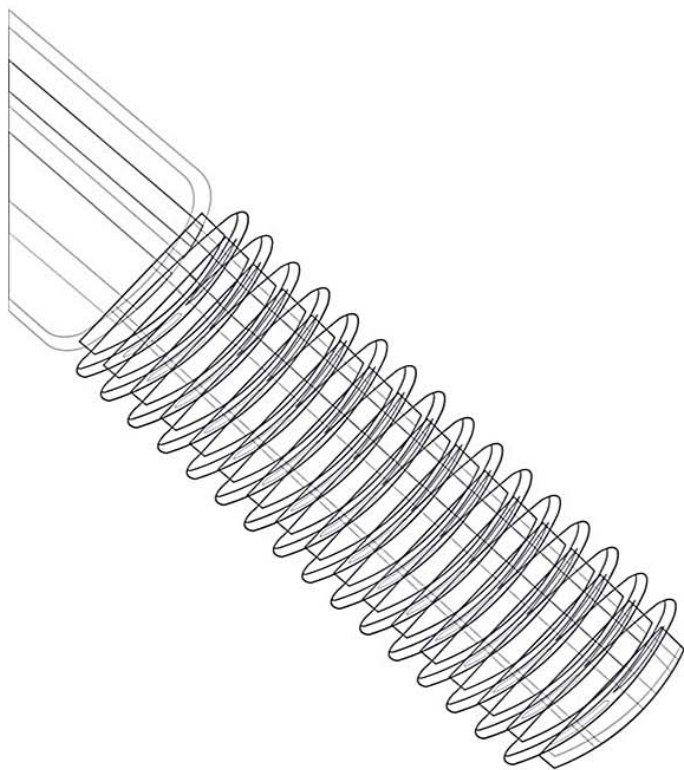

صبغة الهی ♦♦ لصناعة الآلات sebghatollahi manufacturing

Address: Esteghlal St. , Amir Kabir Industrial Area, Isfahan, Iran
Tel: +98 311 3861900 - 3872034 fax: +98 311 3865848
www.namira-co.com info@namira-co.com



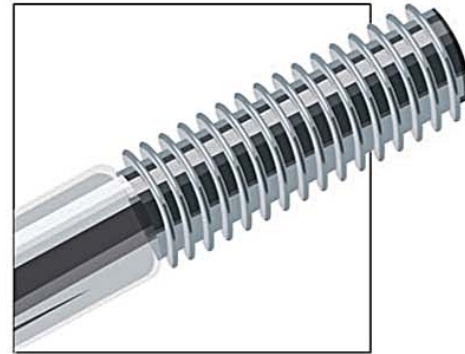

NAMIRA

Sebghatollahi



Manufacturing

Holder of 5 invention
registration certificates
in the Rolling technology field